



Installation instructions

Pendant Twinkle

The Grand Show

Instructions

- Must be installed by a professional
- Handle items carefully
- Use appropriate screws and equipment
- Wear gloves during installation

Assembly time

0h30

Number of people required

2

1

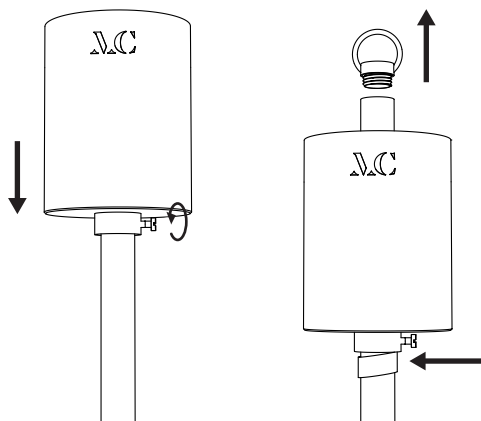

Loosen the screw on the ring slightly to lower the canopy. Place a piece of tape (such as painter's tape) under the ring to prevent the canopy from sliding down further. Unscrew the tube ring at the top.

2

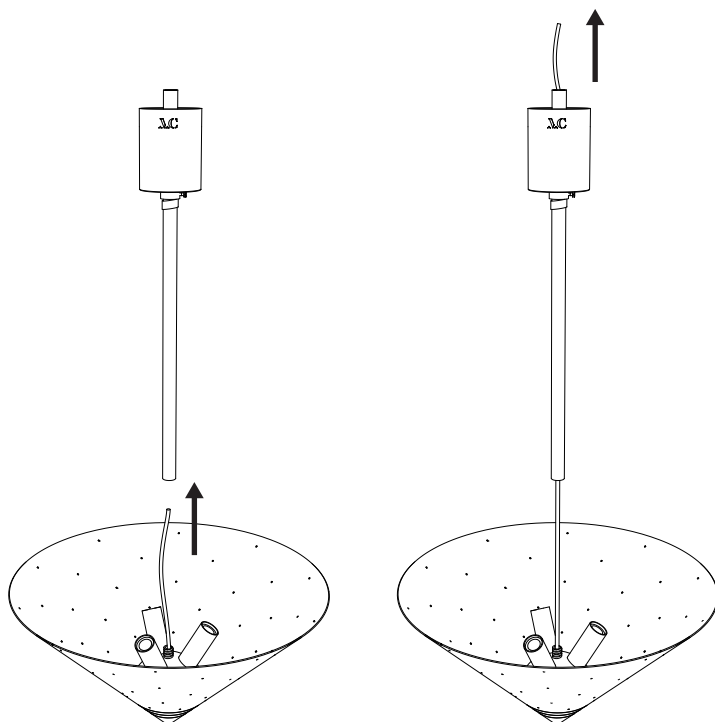

Pass the reflector's electrical cable through the tube and pull it out the other side.

3

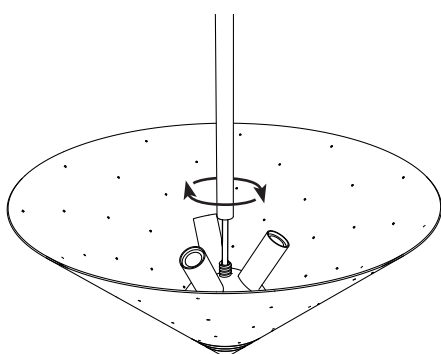

Screw the tube onto the reflector.

4

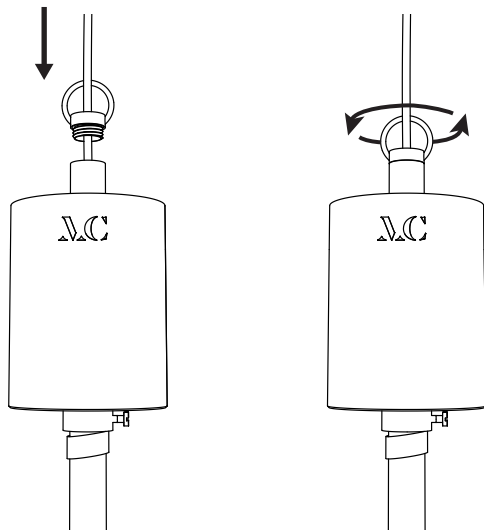

Take the ring previously unscrewed from the tube and pass the electrical cable through it, then screw the ring back onto the tube.

5

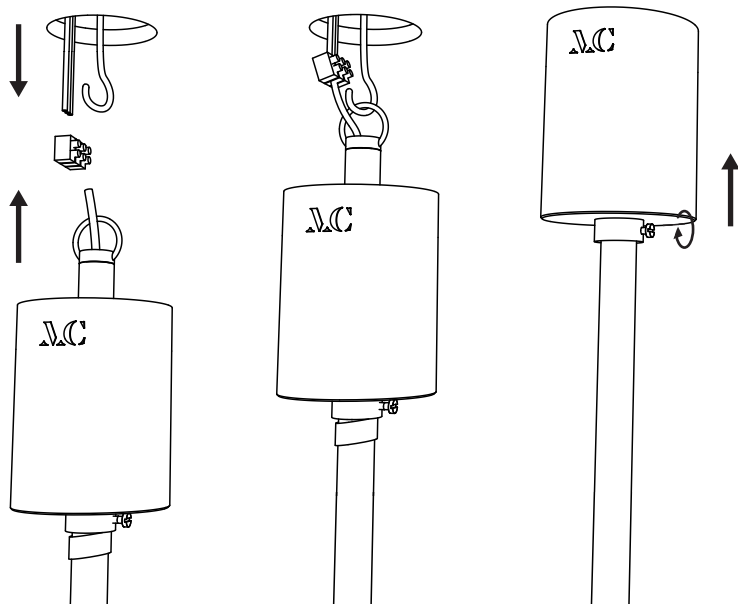

Connect the wires to the electrical network after installing the ring on the hook on the ceiling.
Remove the tape holding the canopy and slide it up. Tighten the screw on the ring.

6

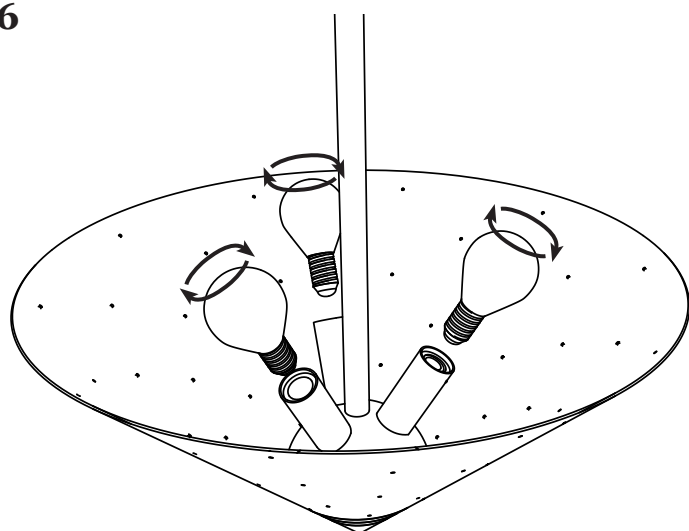

Insert the bulbs into the sockets.